

SAFETY INSTRUCTIONS

Our recessed lighting is certified to the high standards of ETL, FCC and Energy Star (except 6000k and 5CCT). This canless LED recessed light is IC rated and come with a UL connector for greater convenience and safety. But to reduce the risk of death, personal injury, or property damage from fire, electric shock, and other hazards, please read all warnings and instructions on the fixture box and all fixture labels, and read the instructions carefully before proceeding.

WARNING



RISK OF ELECTRIC SHOCK

- ⚠ All electrical connections must be in accordance with local and National Electric Code(N.E.C.) standards.
- ⚠ Consult a qualified electrician if you are unfamiliar with proper electrical wiring connections.
- ⚠ Turn off the switch and circuit breaker before installing this LED light.
- ⚠ Do not alter, relocate or remove wiring.
- ⚠ Double check all connections carefully to make sure they are tight and correct.
- ⚠ Verify that the supply voltage is correct by comparing it with the luminaire label information.

RISK OF FIRE

- ⚠ Keep combustibles and other flammable materials away from lights.
- ⚠ The maximum ambient temperature is 104°F. Do not operate the fixture above this temperature.



STEP-BY-STEP INSTALLATION

TOOLS REQUIRED Saw, Ladder, Measuring Tape, Electrical Wiring (The wire should be AWG14-18 for application to connect the fixture), Safety glasses and gloves.

Notice After the removal of the knockouts (about 0.86-inch diameter) in step No.2, additional cable connectors are needed to secure the wires that pass through the knockouts. You can purchase the cable connectors if needed.

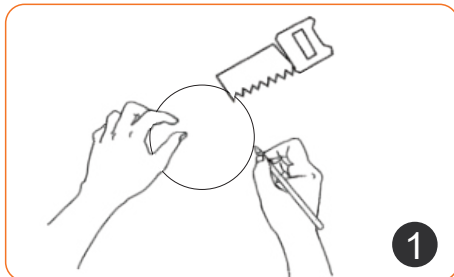

1

Cut a hole according to the 1:1 size of the cutting template.

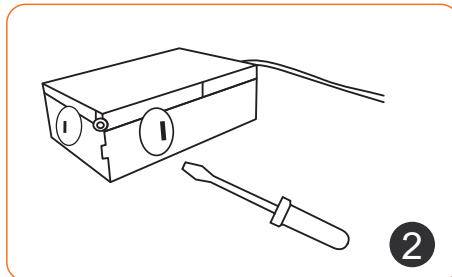

2

Use a screwdriver to twist the knockout piece

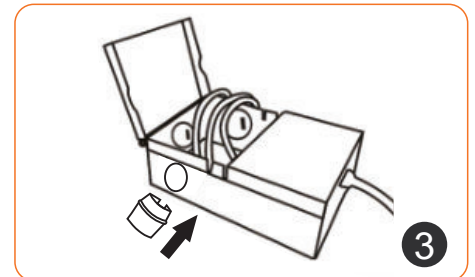

3

Push in the knockout connector.

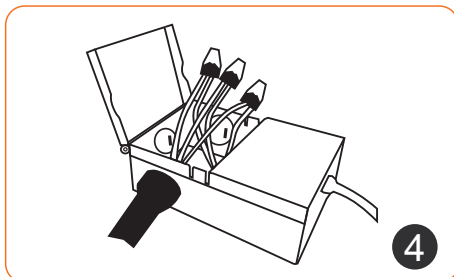

4

Connect the junction box (tightly by hand) to the light panel.

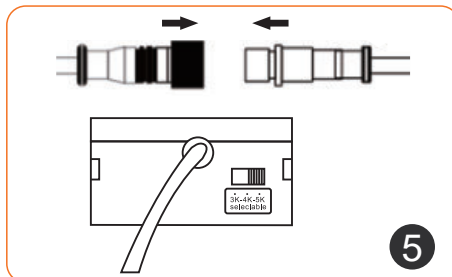

5

Place the box into the ceiling hole. Push up the spring clips.

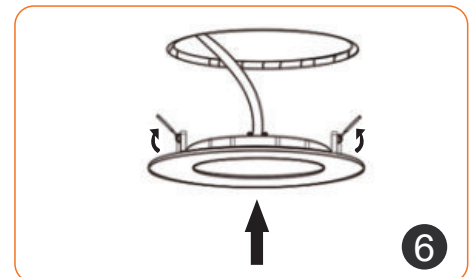

6

Push the light into the ceiling and turn it on.

.1.



SPECIFICATION

Size	3 Inch	4 Inch	6 Inch	8 Inch
Downlight Power	6W	9W	12W	15W
Brightness	540LM	750LM	1050LM	1350LM
Input Voltage	120V			100-277V
Color	Black/White/Bronze/Brushed Nickel			
Dimmable	5-100% dimmable			
Night light Power	3W			
Color Temperature	5CCT+Night Light			
Material	Aluminum			
Special Features	IC Rated & Wet Rated			
Warranty	5 Years			
Certification	ETL,FCC			



HOW TO SWITCH THE MODE?

Flip the wall switch ON-OFF-ON within 2 seconds to change the mode.



Light on in downlight mode

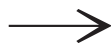

Turn off the light within 2s



Turn on again within 2s to switch to night light mode

NOTE: The light will return to Downlight mode by default after being turned off for over 8 seconds.

.2.