

SAFETY INSTRUCTIONS

Our recessed lighting is certified to the high standards of ETL, FCC and Energy Star (except 6000k and 5CCT). This canless LED recessed light is IC rated and come with a UL connector for greater convenience and safety. But to reduce the risk of death, personal injury, or property damage from fire, electric shock, and other hazards, please read all warnings and instructions on the fixture box and all fixture labels, and read the instructions carefully before proceeding.

WARNING



RISK OF ELECTRIC SHOCK

- ⚠ All electrical connections must be in accordance with local and National Electric Code (N.E.C.) standards.
- ⚠ Consult a qualified electrician if you are unfamiliar with proper electrical wiring connections.
- ⚠ Turn off the switch and circuit breaker before installing this LED light.
- ⚠ Do not alter, relocate or remove wiring.
- ⚠ Double check all connections carefully to make sure they are tight and correct.
- ⚠ Verify that the supply voltage is correct by comparing it with the luminaire label information.

RISK OF FIRE

- ⚠ Keep combustibles and other flammable materials away from lights.
- ⚠ The maximum ambient temperature is 104°F. Do not operate the fixture above this temperature.



STEP-BY-STEP INSTALLATION

TOOLS REQUIRED Saw, Ladder, Measuring Tape, Electrical Wiring (The wire should be AWG14-18 for application to connect the fixture), Safety glasses and gloves.

Notice After the removal of the knockouts (about 0.86-inch diameter) in step No.2, additional cable connectors are needed to secure the wires that pass through the knockouts. You can purchase the cable connectors if needed.

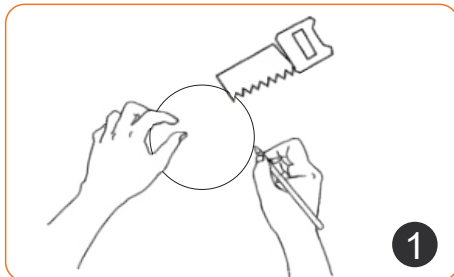

1

Cut a hole according to the 1:1 size of the cutting template.

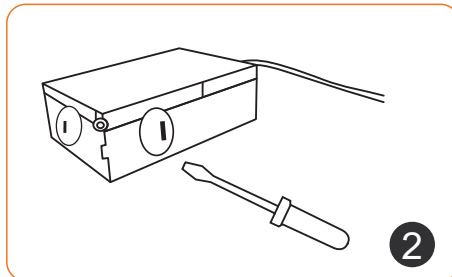

2

Use a screwdriver to twist the knockout piece

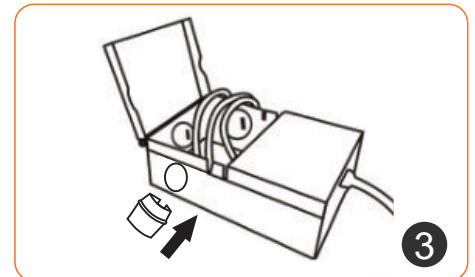

3

Push in the knockout connector.

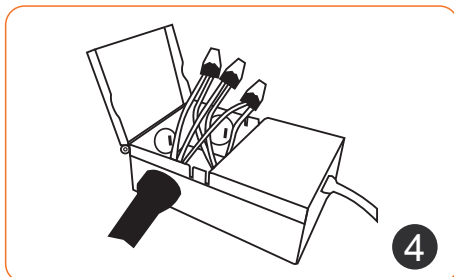

4

Connect the junction box (tightly by hand) to the light panel.

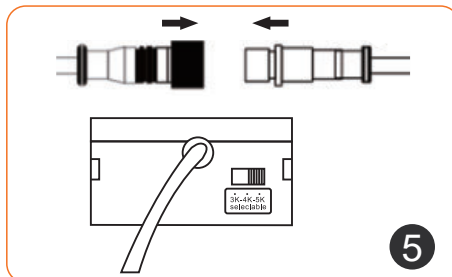

5

Place the box into the ceiling hole. Push up the spring clips.

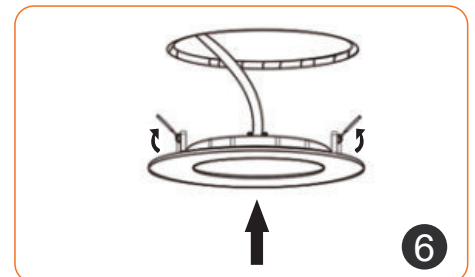

6

Push the light into the ceiling and turn it on.

.1.



SPECIFICATION

Size	4 Inch	6 Inch	8 Inch
Input Power	9W	12W	18W
Brightness	750LM	1050LM	1600LM
Input Voltage	120V		
Color	Black/White/Bronze/Brushed Nickel		
Dimmable	5-100% dimmable		
Color Temperature	2700K/3000K/3500K/4000K/5000K		
Material	Aluminum		
Special Features	IC Rated & Wet Rated		